

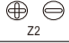

F30

F30CC / F30M

	
Wire 1 and 2	18-6 AWG (0.75-10 mm ²)
	18 lb · in (2 N · m)

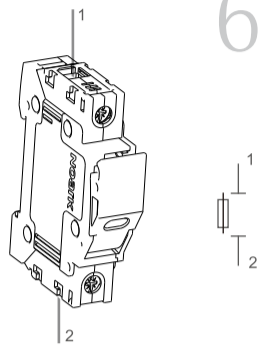

6

F30

F30P

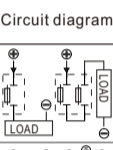
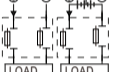
Circuit diagram	Intended System
	Grounded Ungrounded
	Ungrounded Center grounded

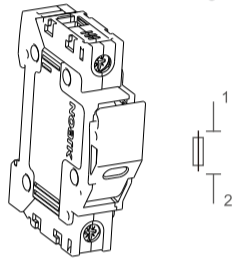

7

F30

This apply to F30*L.

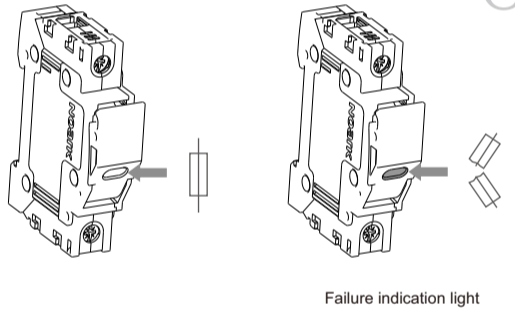

Failure indication light

8

F30

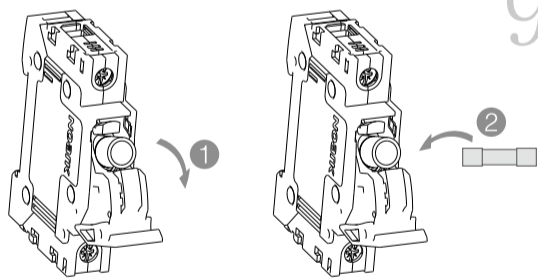

Fuse replacement

9

NOARK



In order to protect the environment, when the product or its components are scrapped, please dispose of it as industrial waste or hand it over to the recycling station for disaggregation, recycling and reuse according to relevant national regulations.

Printed with environment-friendly paper

Copyright Noark. All Rights Reserved

na.noark-electric.com

08/2022

F30

Fuseholders

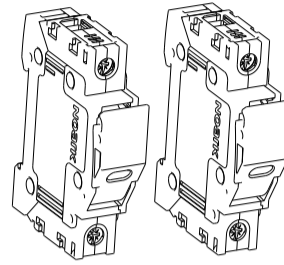

Installation Instructions
Notice d' installation
Instrucciones de montaje

NOARK

F30

 **WARNING**

DO NOT ATTEMPT TO INSTALL OR PERFORM MAINTENANCE ON EQUIPMENT WHILE IT IS ENERGIZED. DEATH, SEVERE PERSONAL INJURY, OR SUBSTANTIAL PROPERTY DAMAGE CAN RESULT FROM CONTACT WITH ENERGIZED EQUIPMENT. ALWAYS VERIFY THAT NO VOLTAGE IS PRESENT BEFORE PROCEEDING WITH THE TASK, AND ALWAYS FOLLOW GENERALLY ACCEPTED SAFETY PROCEDURES.

NOARK IS NOT LIABLE FOR THE MISAPPLICATION OR MISINSTALLATION OF ITS PRODUCTS

F30

F30P / F30M

F30CC

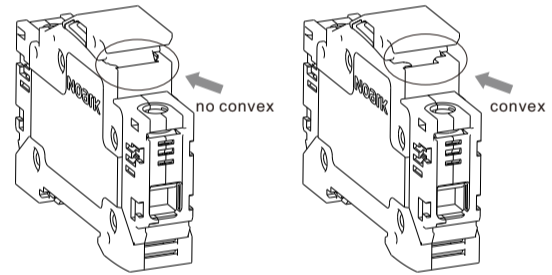

F30

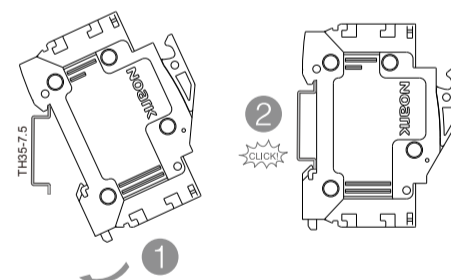

F30

